

# NEXT

QUICK INSTALLATION GUIDE

## Electrical Box Adapter Plate

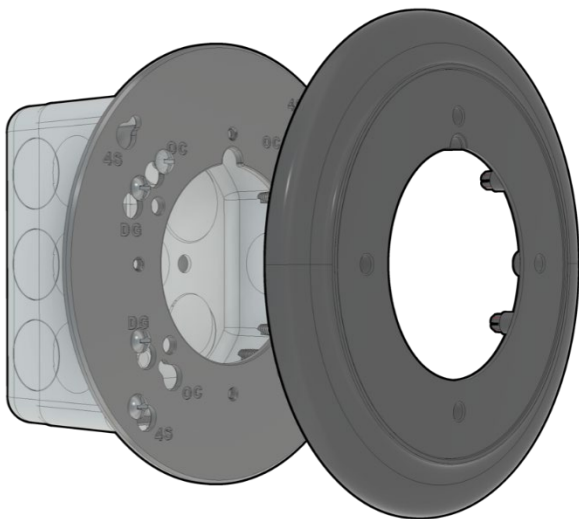

# NOTICES

- This camera operates at PoE (IEEE 802.3at minimum).
- Installation and service should be performed only by qualified and experienced technicians and comply with all local codes and rules to maintain your warranty.
- We are NOT liable of any damage arising either directly or indirectly from inappropriate installation which is not depicted within this documentation.
- To reduce the risk of fire or electric shock during installation, do not expose the product to rain or moisture.
- To remove fingerprints, dust, contaminants, etc., that could occur during installation, wipe the camera with a dry soft cloth. For tough stains, slightly apply a diluted neutral detergent and wipe with a dry soft cloth.
- Do not apply benzene or thinner to the camera, which may cause the surface to melt or lens to fog.
- Avoid aligning the lens with extremely bright objects (e.g., light fixtures) for long periods of time.
- Although this camera is waterproof and suitable for both indoor and outdoor usages, please do not immerse the camera into water.
- Avoid operating or storing the camera in the following locations:
  - Extremely humid, dusty, or hot/cold environments (recommended operating temperature: -40 to 131° F/-40°C to +55°C)
  - Close to sources of powerful radio or TV transmitters
  - Close to fluorescent lamps or objects with reflections
  - Under unstable or flickering light sources
- EN: This product should be supplied by Power-over-Ethernet (PoE).  
The equipment should have on Power over Ethernet (PoE) standards as per IEEE802.3 (42.5-57VDC, 51W),  
Tma is 55 degree C minimum and altitude 5000m.  
If you need further assistance, please contact the manufacturer or brand owner for more information.
- FR: Ce produit doit être alimenté par Power-over-Ethernet (PoE).
- L'équipement doit être conforme aux normes Power over Ethernet (PoE) selon IEEE802.3 (42,5-57 VDC, 51 W),  
la Tma doit être d'au moins 55 degrés C et l'altitude de 5 000 m.
- EN: The equipment powering the Camera should be connected to a socket-outlet with earthing connection.
- FR: L'équipement alimentant la caméra doit être connecté à une prise de courant avec mise à la terre.



**WEEE (Waste Electrical and Electronic Equipment).** Correct disposal of this product (applicable in the European Union and other European countries with separate collection systems). This product should be disposed of, at the end of its useful life, as per applicable local laws, regulations, and procedures.

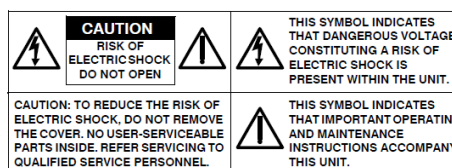

## FC FCC COMPLIANCE STATEMENT

Information to the user: This unit has been tested and found to comply with the limits for a Class A digital device pursuant to Part 15 of the FCC Rules. Operation is subject to the following two conditions: (1) this device may not cause harmful interference, and (2) this device must accept any interference received, including interference that may cause undesired operation. These limits are designed to provide reasonable protection against harmful interference in a residential installation. This unit generates, uses, and can radiate radio frequency energy and, if not installed and used in accordance with the manual, may cause harmful interference to radio communications. However, there is no guarantee that interference will not occur in a particular installation.

**If this unit does cause harmful interference to radio or television reception, which can be determined by turning the unit off and on, the user is encouraged to try to correct the interference by one or more of the following measures:**

- Reorient or relocate the receiving antenna.
- Increase the separation between the unit and receiver.
- Connect the unit to an outlet on a circuit different from that to which the receiver is connected.
- Consult the dealer or an experienced radio/TV technician for help.

**CAUTION** Changes or modifications not expressly approved by the party responsible for compliance could void the user's authority to operate the unit.

**ATTENTION:** Les changements ou modifications non expressément approuvés par la partie responsable de la conformité peuvent annuler le droit de l'utilisateur à utiliser l'appareil.

## **CE STATEMENT**

Operation is subject to the following two conditions: (1) this device may not cause harmful interference, and (2) this device must accept any interference received, including interference that may cause undesired operation. The manufacturer declares that the unit supplied with this guide is compliant with the essential protection requirements of EMC directive and General Product Safety Directive GPSD conforming to requirements of standards EN55032, EN55035, EN61000-3-2, EN61000-3-3, IEC 61000-4-2, IEC 61000-4-3, IEC 61000-4-4, IEC 61000-4-5, IEC 61000-4-6, IEC 61000-4-8, and IEC 61000-4-11 for emission and immunity and UKCA.

This product is IP67 rated for outdoor environments and IK10 rated for impact protection. The camera product also meets regulations required to be NDAA, GSA schedule and TAA approved.

# IN THIS GUIDE

|  |          |
|--|----------|
| <b>ELECTRICAL BOX ADAPTOR PLATE INSTALLATION</b> | <b>4</b> |
| <hr/>  |          |
| <b>PACKAGE CONTENTS</b>                          | <b>4</b> |
| <b>INSTALLATION</b>                              | <b>4</b> |
| Connect the Cables                               | 6        |
| Assemble the Components                          | 7        |
| Install the Camera Sensor                        | 9        |

# ELECTRICAL BOX ADAPTOR PLATE INSTALLATION

## PACKAGE CONTENTS

### Adapter Plate VNX-AC-APBK-0

- Adapter Plate
- Trim Ring
- M4 Screws (4X)
- 6-32 Screws (2X)
- 8-32 Screws (4X)

When unpacking, check to see if there is any visible damage to the appearance of the in-ceiling and its accessories. Remove any protective materials from the bracket after every item is properly checked.

**CAUTION:** To minimize the possibility of moisture being trapped inside the Camera Sensor, keep the sensor module in its factory-sealed bag with the desiccant bag intact until it is ready to be installed.

## INSTALLATION

The NEXT Base can mount directly to a single gang box. When a 4-square, double gang or octagon box is being used, the Electrical Box Adapter Plate is required.

1. The holes on the Adapter Plate are labelled as follows:

- 4S: 4-square box
- OC: octagon box
- DG: double gang box

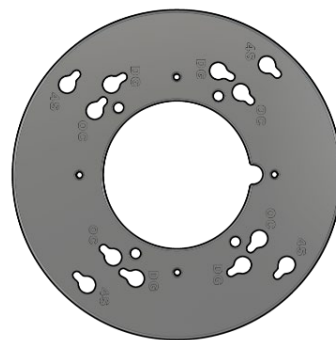
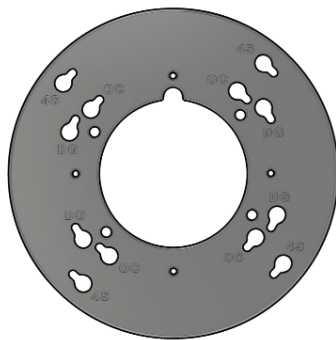

**Adapter Plate Orientation per Gang Box Type**

2. Use either the screws provided (6-32 or 8-32) or the screws that may come with the electrical box and partially install screws in the electrical box.



3. Position the Adapter Plate on the electrical box using the respective keyhole slots for the type of electrical box, rotate the Adapter Plate to the locking position and tighten the screws.

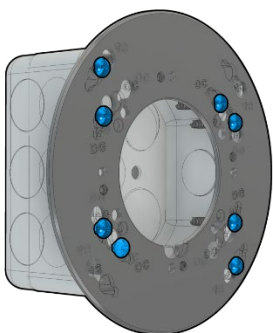

4. Install the Trim Ring onto the Adapter Plate using the orientation indicator (semi-circle) and snap it into place.

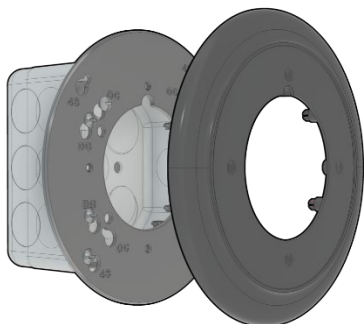

5. Position the Base for the Fixture on the Trim Ring and install using the 4x M4 screws provided.

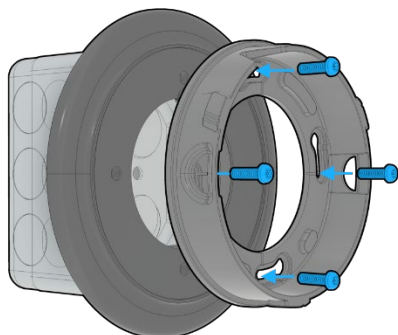

## Connect the Cables

1. Connect Ethernet cable to the RJ-45 on the pigtail of the Network Hub. Connect Alarm I/O cable as required. (Use RJ-45 connector kit as required for outdoor installations.)

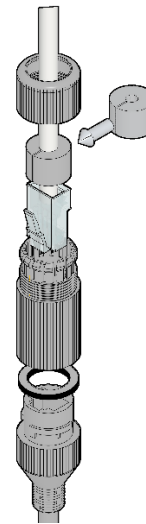
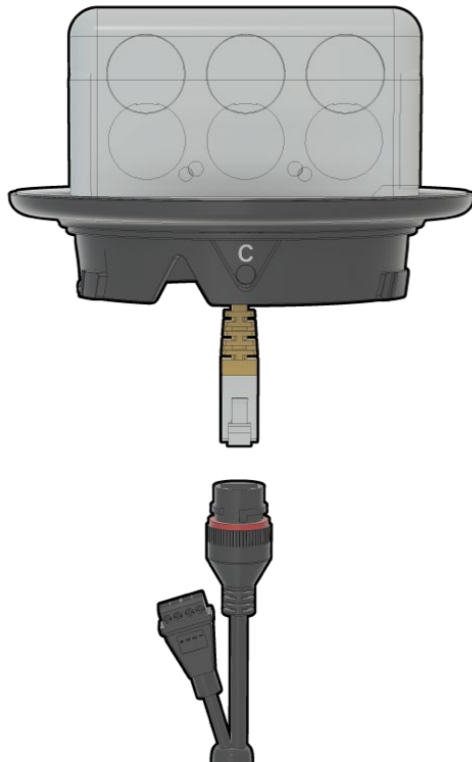

For Outdoor Installations

PIN 1 = ALARM IN -  
PIN 2 = ALARM IN +  
PIN 3 = ALARM OUT -  
PIN 4 = ALARM OUT +

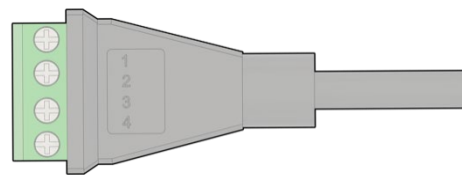

## Assemble the Components

1. Align the single dot indicator on the Network Hub with the dot on the Base and firmly snap the Network Hub into place.

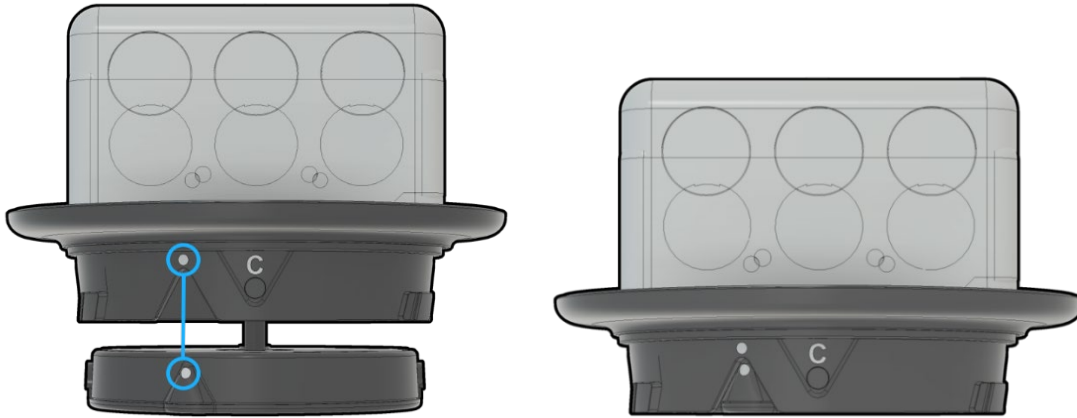

2. Align the two lock screws on the Fixture with the double dot indicators on the installed Network Hub.

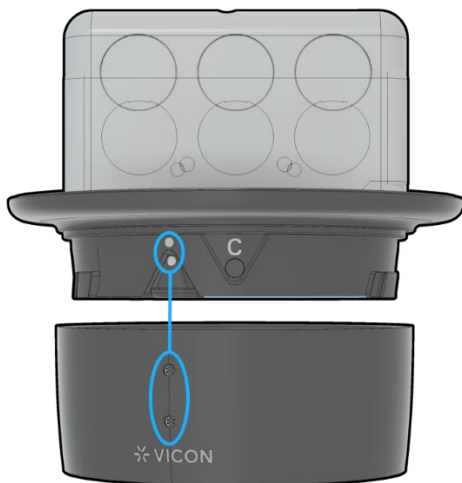

3. Twist the Fixture to the right to lock it into place. The Vicon logo on the Fixture is now aligned with the Base's centerline ("C").





## Install the Camera Sensor

1. Just prior to installation, remove the Camera Sensor from the factory-sealed bag.
2. If using edge recording for On-Prem or Anavio solutions, install a Vicor Edge Recording Card (VNX-EL-SD5G-0 or VNX-EL-SD1T-0).

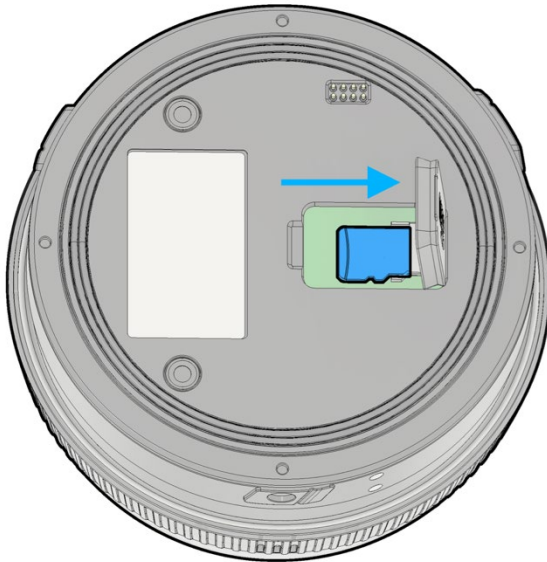

NOTE: Only the Vicor Edge Recording Cards are accepted (VNX-EL-SD5G-0/VNX-EL-SD1T-0).

3. Align the double dot indicators on the Camera Sensor with the two lock screws on the Fixture, then twist it to the right to lock it into place.

NOTE: The NEXT cameras are built with a special membrane to allow internal moisture to vent, ensuring the IP67 rating. However, in certain environments, some moisture vapor may pass through. Upon powering up the camera, there may be some temporary condensation inside the bubble. This is normal and will typically clear on its own within 2-4 hours but may take longer based on the environment.

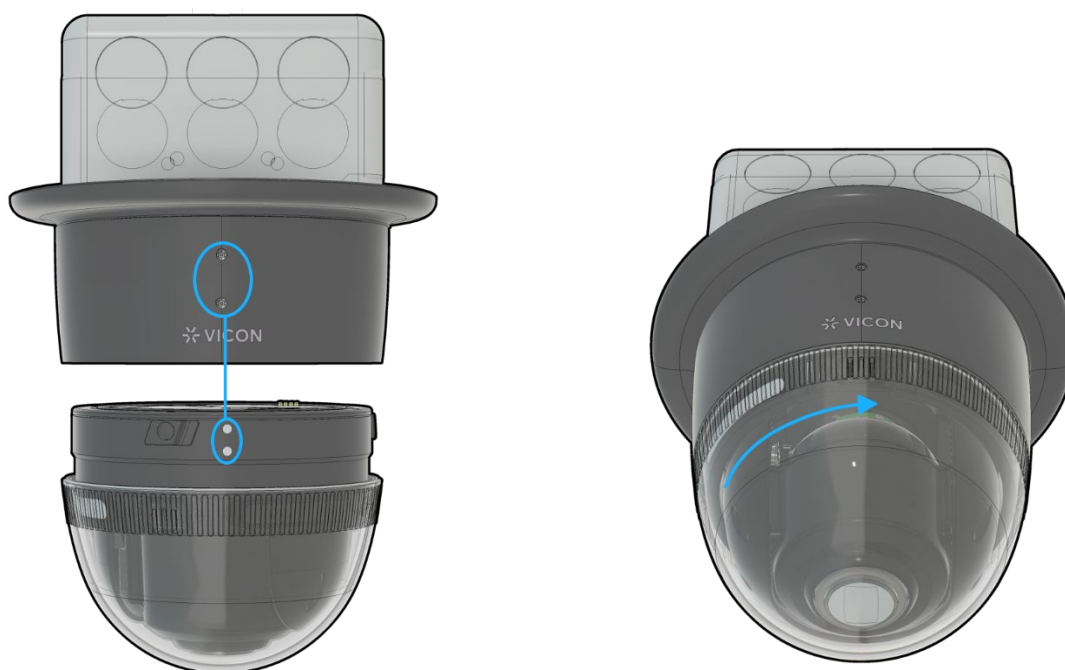

4. Upon successful power-up, the LED lightbars on the Camera Sensor will sequence.
5. Turn the security screw approximately 2 turns maximum until it contacts the Base and Camera Sensor. This prevents the camera from being removed. No torque is required (refer to warning label). For added security, use the T8 Security Torx wrench to gently tighten the two lock screws.

NOTE: Do not overtighten; overtightening can strip the threads.



4. Remove the WARNING label from the Fixture.





Vicon Industries Inc. does not warrant that the functions contained in this equipment will meet your requirements or that the operation will be entirely error free or perform precisely as described in the documentation. This system has not been designed to be used in life-critical situations and must not be used for this purpose.

Document Number: 8009-8344-60-01 Rev: 8/25  
Product specifications subject to change without notice  
Copyright © 2025 Vicon Industries Inc. All rights reserved.

24-Hour Technical Support:  
800-34-VICON (800-348-4266)  
UK: 44/(0) 1489-566300  
Toll Free: 800-645-9116

T: 631-952-2288  
F: 631-951-2288

[vicon-security.com](http://vicon-security.com)