

V2005B

## Roughneck AI Bullet Camera



### Overview

For customers who need to monitor activity in a variety of lighting conditions, from bright light to complete darkness, this bullet camera integrates IR LEDs, True WDR, and Starlight low-light technology, to guarantee superior image quality, regardless of lighting. And the bullet form factor guarantees a water-tight installation.

### AI ANALYTICS INSIDE

#### Perform more meaningful post-event forensic searches with object classification analytics

The camera's object classification analytics allow it to distinguish people and vehicles from other objects in a scene. Object-only recording, and the ability to filter out "environmental noise" that can trigger a motion detection alarm (e.g., shadows, swaying trees and bushes, etc.), significantly increases operational efficiencies. The result?

- Filter out non-relevant video for faster incident resolution
- Reduce storage requirements (by limiting recording to just object-based motion)
- Diminish nuisance alarms
- Respond to genuine threats quicker, and with fewer resources

### Product at a Glance

- ▶ 5 MP resolution
- ▶ Starlight low-light technology provides clear color images in extreme low-light conditions
- ▶ True WDR (120 dB); built-in varifocal autoiris lens
- ▶ Integrated IR provides uniform illumination in total darkness for high-quality video from 131 ft (40 m) away

## Specifications

Model	V2005B
Camera	
Image Sensor:	1/2.8-in
Max Resolution:	2592×1944 (5 MP)
Image Settings:	Digital image effects: defog, flip, mirror, corridor. Configurable brightness, contrast, saturation, hue, sharpness. White balance. BLC. HLC. Gain control. Gamma correction. Electronic shutter speed. Day/night mode. 3 DNR. Motion detection (4 programmable zones). Privacy masking (8 masks). Dynamic ROI. Digital zoom. Event notification.
Intelligent Video Analytics:	Motion, Tampering/Defocus, Intrusion, Loitering, Line Cross, Tailgating, Object Left/Removed, Crowding. Museum Search.
AI-Based Object Classification Analytics:	Vehicles, people, animals
Electronic Shutter Speed:	Auto (1/2 ~ 1/10,000 sec), manual
Day/Night Performance:	True day/night (IR cut filter)
Wide Dynamic Range	True WDR; 120 dB
Minimum Illumination (@ 30 IRE):	Color: 3.1-10 mm: 0.03 lux or 8-18 mm: 0.02 lux BW: 0.01 lux, IR Off; 0 lux, IR On
IR Distance:	Smart IR/Adaptive IR. 131 ft (40 m); 4 IR LEDs
Lenses	
Focal Length:	3.1-10 mm: 3.2X optical zoom or 8-18 mm: 2.25X optical zoom
Max. Aperture:	3.1-10 mm: f/1.4 - f/2.8 or 8-18 mm: f/1.6- f/2.8
Iris:	DC autoiris
Zoom/Focus Adjust:	Motorized zoom and focus
Field-of-View:	3.1-10 mm: H: 32° (tele) - 96° (wide) V: 24° (tele) - 69° (wide) 8-18 mm: H: 19° (tele) - 40° (wide)/ V: 13° (tele) - 29° (wide)
Network Video Transmission	
Network:	10/100Base-T/TX: RJ-45
Image Compression:	H.264; H.265; M-JPEG
Resolution:	2592×1944/1520, 2560×1440, 2048×1536, 2304×1296, 1920×1080 (1080P), 1600×1200, 1440×1080, 1600×900, 1280×960/720, 800×600, 640×480/360, 320×240/180
Protocol:	ARP, DHCP, DNS, FTP, HTTP, HTTPS, HLS, ICMP, IGMP, IPv4/6, LDAP, NTP, RTSP/RTCP/RTP, RTMP, QoS, SMTP, SNMP v1/2c/3, TCP, TLS/TTLS, UDP, UPnP, 802.1X, UPnP, Bonjour, DDNS, PPPoE; ONVIF S/G/T/M
Frame Rate:	30/25 fps max
Streams (Triple Streaming):	Single: 5 MP@30fps Dual: 5 MP@30fps + 1600×1200@30fps Triple: 5 MP@30fps + 1600×1200@30fps + 640 x 480@30 fps
Alarms:	1 alarm input/1 alarm output
Audio:	1 audio input/1 audio output (line in/out); G.711 (a-law, μ-law); audio level alarm
Users:	Live: 10 users
Web Browser:	Chrome®, Safari®, Firefox®, Microsoft Edge®
Security:	IP address filtering, HTTPS encrypted data transmission, SSL, IEEE 802.1X, Digest Authentication, Advanced Security

## Specifications

Model	V2005B
Mechanical	
Construction:	Housing: white aluminum. Sunshield: PC + ABS.
Camera Angle of Adjustment:	Adjusted using integral wall mount. Mechanical camera adjustment pan/tilt.
Mounting:	Surface mount, wall or ceiling
Dimensions:	3.5 in. (89 mm) (Diam) x 10.3 (261 mm) (L)
Weight:	4.0 lb (1.8 kg)
Electrical	
Input Power:	PoE+ IEEE 802.3 at class 4; 12 VDC ( $\pm 10\%$ ); 24 VAC (+20%/-10%)
Current:	12 VDC: 1.67 A; 24 VAC: 0.83 A; PoE: 0.42 A
Power Consumption:	IR/Heaters On: 20 W IR Off/Heaters On: 14 W IR Off/Heaters Off: 6.7 W
Controls and Connectors	
Connectors:	Pigtail cable provided; optional backbox required for cabling. Power: 12 VDC/24 VAC: terminal block; PoE/Network: RJ-45 CAT 5; Alarm Input/Output: terminal block. Audio Input/Output: terminal block. Reset button; Default button; Micro SD card slot for SDHC/SDXC card (128 G max; customer-supplied)
Environmental	
Dual Heater System:	For low temperature operation: heater turns on at -40° F (-40° C) and off at 59° F (15° C) For defog operation: heater turns on at -40° F (-40° C) and off at 140° F (60° C)
Operating Conditions:	Outdoor-rated Temp: -40° to 140° F (-40° to 60° C) Humidity: up to 90%, non-condensing
Approvals:	UL, FCC Class A, CE, IP67, IK10 (including front glass); ONVIF Profile S/T/G/M, RoHS, BIS (excluding 8-18 mm models)
Country of Origin:	Taiwan
Warranty:	5 years

## Dimensional Drawing

[in. (mm)]

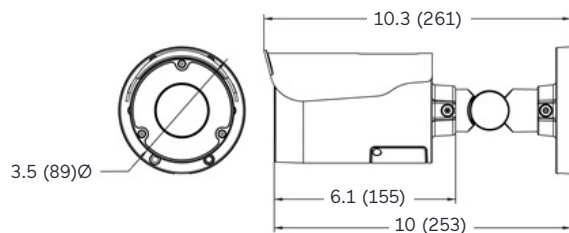

## Pigtail Cable:

Use optional V2000B-BOX (sold separately)

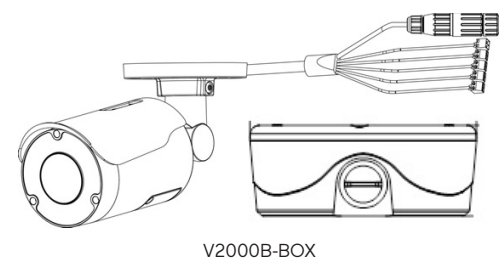

## Ordering Information

Model	Description
V2005B-W313MIR	<b>5 MP Bullet</b> 3.1-10 mm motorized zoom and focus; autoiris; includes object classification analytics.
V2005B-W818MIR	<b>5 MP Bullet</b> 8-18 mm motorized zoom and focus; autoiris; includes object classification analytics.
<b>Mounts and Accessories</b>	
V2000B-PLATE	<b>Adapter Plate</b> Allows the V2000B to be mounted on a 4x4 electrical box.
V2000B-BOX	<b>Backbox</b> For ease of cabling for the V2000B; compatible with V-24CMB-4 corner mount and V-20B-A-4 pole mount adapter.
V-24CMB-4	<b>Corner Mount</b> For mounting the V2000B to a corner.
V-20B-A-4	<b>Pole Mount</b> For mounting the V2000B to a pole.



V2000B-PLATE



V2000B-BOX



V-20B-A-4



V-24CMB-4