

July 2017

SN663V-B, SN673V-B, SN680D-B-WINR, V921B, V922B, V922D, V932EZ and V-CELL-HD-A Camera Firmware

General Description

Vicon has released firmware for production for the cameras listed below. The accompanying SmartManager discovery tool has not been updated for this release. It is still at version v2.3.3.11.

These cameras and firmware versions have been tested and validated with Vicon's Valerus VMS and with ViconNet V8.x.

Camera	Older Firmware	Newest Firmware
SN663V-B SN673V-B SN680D-B-WNIR	X2_v1.4.9 and greater	For all X2 architecture products the X2_V2.1.71 firmware was released in July, 2017. If updating from a version earlier than X2_1.4.9, please first update to X2_1.4.9 and then to X2_V2.1.71.
V932EZ-W312MIR	X2_v1.9.8 and greater	
V921B-W39MIR-A V922-D4129 V922B-W39MIR-A V922B-W551MIR-A V922B-W551MLPC V922D-W39IR-A V922D-W39IR-ME V922D-W39MIR-A V922D-W39MIR-ME V972D-W312IR	X2_v1.9.63 and greater	
V-CELL-HD-A	X2_v1.9.8 and greater	

Vicon Production

The latest firmware and discovery tool are available on Vicon's website. A link is provided in the installation section of this document. Manufacturing has switched over to the new firmware for new camera production.

This is not a mandatory update. However, updating is recommended for cameras intended to work with Vicon's Valerus VMS or other ONVIF-based VMS systems. For other applications, please review the release notes to help determine if the fixes included are relevant to your environment.

Please review the upgrade instructions described at the end of this document.

New Features

ONVIF Protocol G

Support has been added for local SD card storage using ONVIF protocol G.

Corrected Issues

Nessus Lighttpd Issues

A number of issues flagged by the Nessus security scanner in the Lighttpd web server have been corrected.

Static IP Address Removal

Rather than using a static IP address the camera will now attempt to get a DHCP response. If no DHCP response is received the camera will be reachable by a self-assigned (APIPA) address in the 169.254.x.x range.

Known Issues

Analytics Configuration

Analytics configuration pages in the camera web pages are supported in Internet Explorer only.

Video Streaming on Genetec

One H.264 and one MJPEG may be recorded and viewed when used with the Genetec VMS.

Installing the Updated Firmware

The latest firmware is available on Vicon's website from the Software Downloads tab: a link is provided below.

<http://www.vicon-security.com/software-downloads-library/vicon-camera-software/>

Download the firmware to your PC. Go to the camera's Maintenance screen.

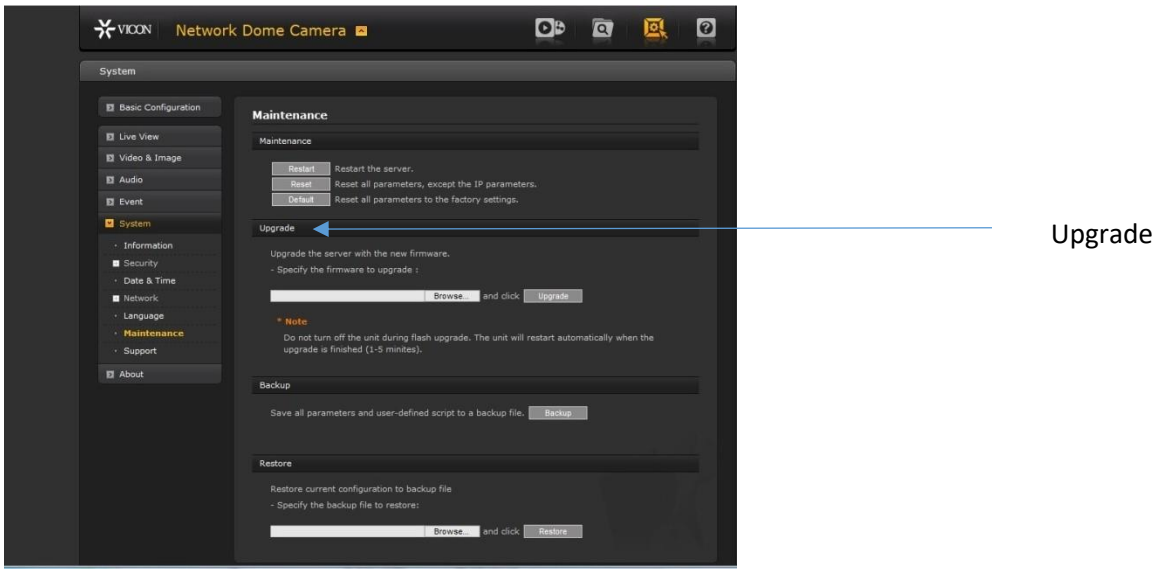

Open the Upgrade section and use the Browse button to locate the firmware on your PC. Press the upgrade button. During the upgrade process, do not turn off power to the camera. Wait at least 5 minutes and access the camera again.

Once complete, the firmware version can be checked from the Basic Configuration screen.

